



rtc[®]

QUICK CONNECT TECHNOLOGY
www.rtc-tec.com



090 rtc TYPE





European profile

Temperature Range - Temperaturbereich
-5°C +180°C (+23°F +356°F) FPM (V)

Working Pressure - Betriebsdruck

rtc 090.06 0 - 10 bar (0 - 145 PSI)
rtc 090.09 0 - 15 bar (0 - 217 PSI)
rtc 090.13 0 - 15 bar (0 - 217 PSI)

Flow size - Nennweiten

rtc 090.06 6 mm
rtc 090.09 9 mm
rtc 090.13 13 mm

Standard version - Standardversion

Brass - Messing
FPM (V) PTFE coated - Viton PTFE beschichtet

Material

Socket Body-	Brass -
Kupplungsgrundkörper	Messing
Sleeve - Hülse	Brass - Messing
Valve - Ventil	Brass - Messing
Springs - Federn	Stainless steel - Edelstahl
Locking Ring - Sprengring	Stainless steel - Edelstahl
Balls - Kugeln	Stainless steel - Edelstahl
Seals - Dichtungen	FPM (V)
Plug - Nippel	Brass - Messing

Options - Optionen

Stainless Steel - Edelstahl
Safety lock - Sicherheitsentriegelung

Using Area

- On temperature regulation applications with hot or cold water, oil etc
- Injection moulding industries
- On steam line

Anwendungsbereiche

- Werkzeugtemperierung
- Kühlung mit Öl oder Wasser
- Kunststoffindustrie
- Dampfanwendungen



Safety type coupler for disconnect protection
Sicherheitsfunktion für das ungewollte Trennen

Add "S" to item code / Fügen Sie "S" zur Artikelnummer hinzu

Flow Rate vs Pressure Drop Graph

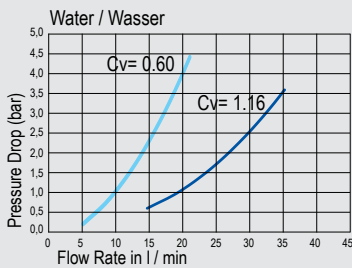

— 090.06 = Free passage 090.06 = Freier Durchgang
— 090.06 = Shut-off 090.06 = Absperrend

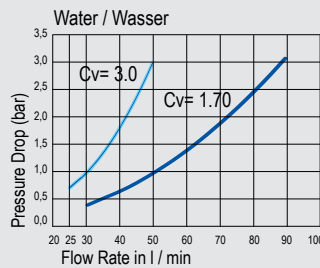

— 090.09 = Free passage 090.09 = Freier Durchgang
— 090.09 = Shut-off 090.09 = Absperrend

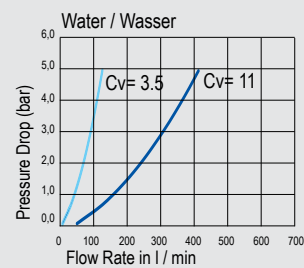

— 090.13 = Free passage 090.13 = Freier Durchgang
— 090.13 = Shut-off 090.13 = Absperrend

090
rtc TYPE

rtc TYPE 090

Standard hose tail socket / Kupplung mit gerader Standard - Schlauchtülle



Sockets / Kupplungen

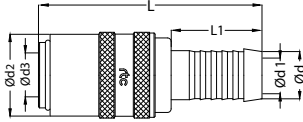

Size / Größe	Order No / Bestellnr. With Valve / Mit Ventil	Order No / Bestellnr. Without Valve / ohne Ventil	Ød	Ød1	Ød2	Ød3	L	L1
6	090.06 SHB 06	090.06 SHF 06	6	4	17	9	53	22.5
6	090.06 SHB 09	090.06 SHF 09	9	7	17	9	53	22.5
6	090.06 SHB 13	090.06 SHF 13	13	10	17	9	55	25
9	090.09 SHB 09	090.09 SHF 09	9	7	22	13	61.5	25
9	090.09 SHB 13	090.09 SHF 13	13	10	22	13	61.5	25
13	090.13 SHB 16	090.13 SHF 16	16	13	31	19	93	25
13	090.13 SHB 19	090.13 SHF 19	19	16	31	19	100	32

rtc TYPE 090

Push to connect hose tail socket / Kupplung mit gerader Schnellsteck - Schlauchtülle



Sockets / Kupplungen

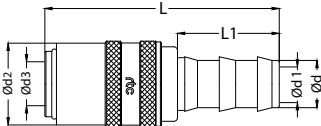

Size / Größe	Order No / Bestellnr. With Valve / Mit Ventil	Order No / Bestellnr. Without Valve / ohne Ventil	Ød	Ød1	Ød2	Ød3	L	L1
6	090.06 SPB 10	090.06 SPF 10	10	8	17	9	59	24
9	090.09 SPB 10	090.09 SPF 10	10	8	22	13	65	24
9	090.09 SPB 13	090.09 SPF 13	13	10	22	13	65	28
13	090.13 SPB 16	090.13 SPF 16	16	13	31	19	96	38
13	090.13 SPB 19	090.13 SPF 19	19	15	31	19	96	38

rtc TYPE 090

Standard hose tail socket 45° / Kupplung mit 45° Standard - Schlauchtülle



Sockets / Kupplungen

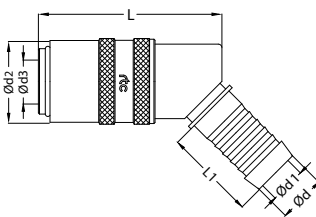

Size / Größe	Order No / Bestellnr. With Valve / Mit Ventil	Order No / Bestellnr. Without Valve / ohne Ventil	Ød	Ød1	Ød2	Ød3	L	L1
6	090.06 SHB 06 45	090.06 SHF 06 45	6	4	17	9	42	22.5
6	090.06 SHB 09 45	090.06 SHF 09 45	9	7	17	9	42	22.5
9	090.09 SHB 09 45	090.09 SHF 09 45	9	7	22	13	51	25
9	090.09 SHB 13 45	090.09 SHF 13 45	13	10	22	13	51	25
13	090.13 SHB 19 45	090.13 SHF 19 45	19	16	31	19	78	32

rtc TYPE 090

Push to connect hose tail socket 45° / Kupplung mit 45° Schnellsteck - Schlauchtülle



Sockets / Kupplungen

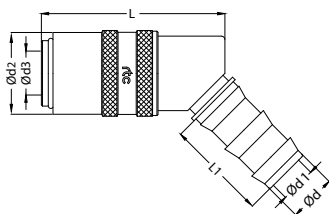

Size / Größe	Order No / Bestellnr. With Valve / Mit Ventil	Order No / Bestellnr. Without Valve / ohne Ventil	Ød	Ød1	Ød2	Ød3	L	L1
6	090.06 SPB 10 45	090.06 SPF 10 45	10	6	17	9	42	24
9	090.09 SPB 10 45	090.09 SPF 10 45	10	8	22	13	51	24
9	090.09 SPB 13 45	090.09 SPF 13 45	13	10	22	13	51	28
13	090.13 SPB 19 45	090.13 SPF 19 45	19	15	31	19	78	38



Standard hose tail socket 90° / Kupplung mit 90° Standard - Schlauchtülle

TYPE 090



Sockets / Kupplungen

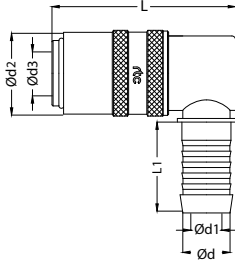

Size / Größe	Order No / Bestellnr. With Valve / Mit Ventil	Order No / Bestellnr. Without Valve / ohne Ventil	Ød	Ød1	Ød2	Ød3	L	L1
6	090.06 SHB 06 90	090.06 SHF 06 90	6	4	17	9	42	22.5
6	090.06 SHB 09 90	090.06 SHF 09 90	9	7	17	9	42	22.5
9	090.09 SHB 09 90	090.09 SHF 09 90	9	8	22	13	51	30
9	090.09 SHB 13 90	090.09 SHF 13 90	13	10	22	13	51	30
13	090.13 SHB 19 90	090.13 SHF 19 90	19	16	31	19	78	32



Push to connect hose tail socket 90° / Kupplung mit 90° Schnellsteck - Schlauchtülle

TYPE 090



Sockets / Kupplungen

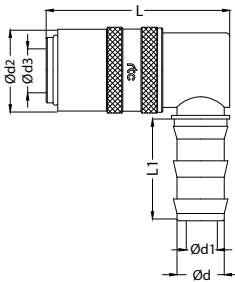

Size / Größe	Order No / Bestellnr. With Valve / Mit Ventil	Order No / Bestellnr. Without Valve / ohne Ventil	Ød	Ød1	Ød2	Ød3	L	L1
6	090.06 SPB 10 90	090.06 SPF 10 90	10	8	17	9	42	33
9	090.09 SPB 10 90	090.09 SPF 10 90	10	8	22	13	51	33
9	090.09 SPB 13 90	090.09 SPF 13 90	13	10	22	13	51	33
13	090.13 SPB 19 90	090.13 SPF 19 90	19	15	31	19	78	38



Cylindrical male thread socket / Kupplung mit Aussengewinde zylindrisch

TYPE 090



Sockets / Kupplungen

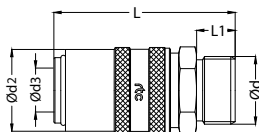

Size Größe	Order No / Bestellnr. With Valve / Mit Ventil	Order No / Bestellnr. Without Valve / ohne Ventil	Ød	Ød2	Ød3	L	L1	HEX.
6	090.06 SMB 13	090.06 SMF 13	BSP 1/4	17	9	48	9	17
6	090.06 SMB 17	090.06 SMF 17	BSP 3/8	17	9	48	9	19
6	090.06 SMB 1415	090.06 SMF 1415	M14x1.5	17	9	48	9	17
6	090.06 SMB 1615	090.06 SMF 1615	M16x1.5	17	9	48	9	19
9	090.09 SMB 13	090.09 SMF 13	BSP 1/4	22	13	52	9	22
9	090.09 SMB 17	090.09 SMF 17	BSP 3/8	22	13	52	9	22
9	090.09 SMB 21	090.09 SMF 21	BSP 1/2	22	13	52	10	24
9	090.09 SMB 1615	090.09 SMF 1615	M16x1.5	22	13	52	9	22
13	090.13 SMB 21	090.13 SMF 21	BSP 1/2	31	19	74	12	30
13	090.13 SMB 26	090.13 SMF 26	BSP 3/4	31	19	78	16	30
13	090.13 SMB 2415	090.13 SMF 2415	M24x1.5	31	19	78	16	30



Cylindrical male thread socket 45° / Kupplung mit 45° Aussengewinde zylindrisch

TYPE 090



Sockets / Kupplungen

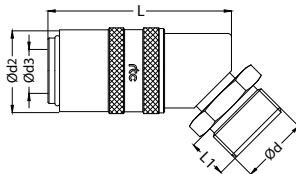

Size Größe	Order No / Bestellnr. With Valve / Mit Ventil	Order No / Bestellnr. Without Valve / ohne Ventil	Ød	Ød2	Ød3	L	L1	HEX.
6	090.06 SMB 13 45	090.06 SMF 13 45	BSP 1/4	17	9	42	9	17
6	090.06 SMB 17 45	090.06 SMF 17 45	BSP 3/8	17	9	42	9	19
6	090.06 SMB 1415 45	090.06 SMF 1415 45	M14x1.5	17	9	42	9	17
6	090.06 SMB 1615 45	090.06 SMF 1615 45	M16x1.5	17	9	42	9	19
9	090.09 SMB 17 45	090.09 SMF 17 45	BSP 3/8	22	13	51	9	22
9	090.09 SMB 1615 45	090.09 SMF 1615 45	M16x1.5	22	13	51	9	22
13	090.13 SMB 2415 45	090.13 SMF 2415 45	M24x1.5	31	19	80	18	30

rtc TYPE 090 Cylindrical male thread socket 90° / Kupplung mit 90° Aussengewinde zylindrisch

Size Größe	Order No / Bestellnr. With Valve / Mit Ventil	Order No / Bestellnr. Without Valve / ohne Ventil	Ød	Ød2	Ød3	L	L1	HEX.
6	090.06 SMB 13 90	090.06 SMF 13 90	BSP 1/4	17	9	42	9	17
6	090.06 SMB 17 90	090.06 SMF 17 90	BSP 3/8	17	9	42	9	19
6	090.06 SMB 1415 90	090.06 SMF 1415 90	M14x1.5	17	9	42	9	17
6	090.06 SMB 1615 90	090.06 SMF 1615 90	M16x1.5	17	9	42	9	19
9	090.09 SMB 17 90	090.09 SMF 17 90	BSP 3/8	22	13	51	9	22
9	090.09 SMB 1615 90	090.09 SMF 1615 90	M16x1.5	22	13	51	9	22
13	090.13 SMB 2415 90	090.13 SMF 2415 90	M24x1.5	31	19	88	18	30

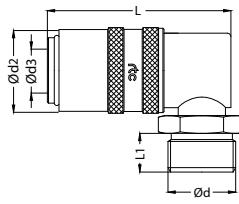

rtc TYPE 090 Cylindrical female thread socket / Kupplung mit Innengewinde zylindrisch

Size Größe	Order No / Bestellnr. With Valve / Mit Ventil	Order No / Bestellnr. Without Valve / ohne Ventil	Ød	Ød2	Ød3	L	HEX.
6	090.06 SFB 13	090.06 SFF 13	BSP 1/4	17	9	42	17
6	090.06 SFB 17	090.06 SFF 17	BSP 3/8	17	9	42	21
6	090.06 SFB 1415	090.06 SFF 1415	M14x1.5	17	9	42	17
9	090.09 SFB 13	090.09 SFF 13	BSP 1/4	22	13	45	22
9	090.09 SFB 17	090.09 SFF 17	BSP 3/8	22	13	46	22
9	090.09 SFB 21	090.09 SFF 21	BSP 1/2	22	13	49	22
9	090.09 SFB 1615	090.09 SFF 1615	M16x1.5	22	13	49	22
13	090.13 SFB 26	090.13 SFF 26	BSP 3/4	31	19	78	33

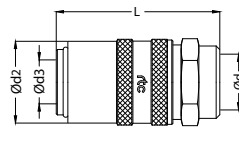

rtc TYPE 090 Cylindrical male thread socket short version / Kupplung mit Aussengewinde zylindrisch kurze Version

Size Größe	Order No / Bestellnr. Without Valve / Ohne Ventil	Ød	Ød2	Ød3	L	L1	HEX.
6	090.06 SMB 13x38	BSP 1/4	17	9	38	9	17
9	090.09 SMB 17x38	BSP 3/8	22	13	38	9	21

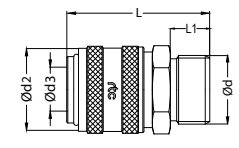

rtc TYPE 090 Diverting sockets / Umlenkkupplung

Size Größe	Order No / Bestellnr. Without Valve / Ohne Ventil	Ød	Ød1	Ød2	L	L1	L2
6	090.06 SCF 125	9	17	8x1	44	125	2
6	090.06 SCF 250	9	17	8x1	44	250	2
6	090.06 SCF 500	9	17	8x1	44	500	2
9	090.09 SCF 125	13	22	10x1	51	125	2
9	090.09 SCF 250	13	22	10x1	51	250	2
9	090.09 SCF 500	13	22	10x1	51	500	2
13	090.13 SCF 160	19	34	14x1	80	160	3
13	090.13 SCF 315	19	34	14x1	80	315	3
13	090.13 SCF 500	19	34	14x1	80	500	3

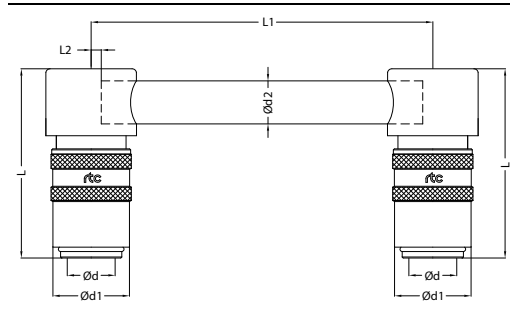

Size Größe	Order No / Bestellnr. Without Valve / Ohne Ventil	Ød	Ød1	Ød2	Ød3	L	L1
6	090.06 SCF 00	9	17	8x1	20	44	37
9	090.09 SCF 00	13	22	10x1	26	51	42
13	090.13 SCF 00	19	34	14x1	36	80	67

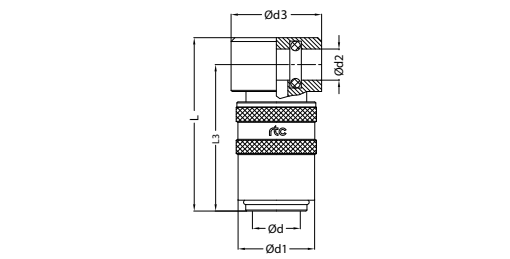

Brass Tube Messing Rohr	Ød	Ød1	Length Länge
TBM 0810x1000	8	6	1000mm
TBM 1010x1000	10	8	1000mm
TBM 1410x1000	14	12	1000mm

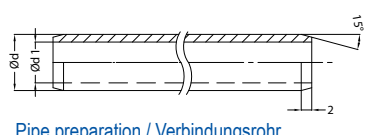

Pipe preparation / Verbindungsrohr



Adapting Socket with plug / Adapterkupplung mit Nippel

TYPE 090



Sockets and Plugs / Kupplung und Nippel

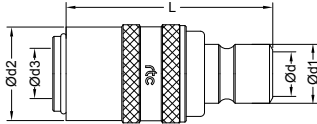
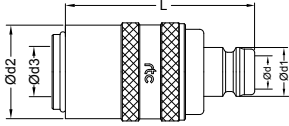

Order No / Bestellnr. With Valve / Mit Ventil	Order No / Bestellnr. Without Valve / Ohne Ventil	Plug Size Nippel Größe (Ød)	Ød1	Ød2	Socket Size Kupplung Größe (Ød3)	L	Passage
090.06 SXB 090.06	090.06 SXF 090.06	6	9	17	9	45	6
090.06 SXB 090.09	090.06 SXF 090.09	9	13	17	9	45	6
090.09 SXB 090.06	090.09 SXF 090.06	6	9	22	13	50.5	6
090.09 SXB 090.09	090.09 SXF 090.09	9	13	22	13	50.5	9
090.06 SXB 099.06	090.06 SXF 099.06	6	9.5	17	9	47.5	6
090.06 SXB 099.09	090.06 SXF 099.09	9	13.5	17	9	47.5	6
090.09 SXB 099.06	090.09 SXF 099.06	6	9.5	22	13	52	6
090.09 SXB 099.09	090.09 SXF 099.09	9	13.5	22	13	52	9

Blind Socket / Blindkupplung

TYPE 090



Sockets / Kupplungen

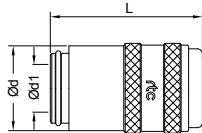

Order No / Bestellnr.	Body Size Größe (Ød)	Ød1	L
090.06 PL 00	6	17	30
090.09 PL 00	9	22	37
090.13 PL 00	13	31	58

Blind Plug / Blindnippel

TYPE 090



Plugs / Nippel

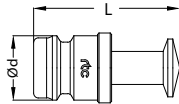

Order No / Bestellnr.	Body Size Größe (Ød)	Ød	L
090.06 SL 00	6	9	28
090.09 SL 00	9	13	30
090.13 SL 00	13	19	52



Adapting Plug / Adapternippel

TYPE 090



Plugs / Nippel

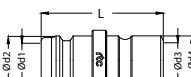
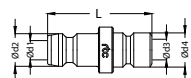
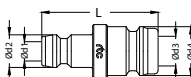
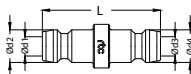

Order No / Bestellnr.	Ød1	Ød2	Ød3	Ød4	L
090.06 PXP 090.06	6	9.5	6	9.5	34
090.06 PXP 090.09	6	9.5	9	13	34
090.09 PXP 090.09	9	13	9	13	34
090.09 PXP 099.06	9	13	6	9.5	29
090.09 PXP 099.09	9	13	9	13.5	36

rtc TYPE 090.06

Cylindrical male thread plug / Nippel mit Aussengewinde zylindrisch

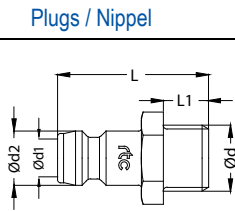

Plugs / Nippel	Size Größe	Order No / Bestellnr.	Ød	Ød1	Ød2	L	L1	HEX.
	6	090.06 PMF 10	BSP 1/8	6	9	24	7	11
	6	090.06 PMF 13	BSP 1/4	6	9	26	9	14
	6	090.06 PMF 17	BSP 3/8	6	9	26	9	17
	6	090.06 PMF 1010	M10x1	6	9	24	7	11
	6	090.06 PMF 1415	M14x1.5	6	9	26	9	15
	6	090.06 PMF 1615	M16x1.5	6	9	26	9	17

rtc TYPE 090.09

Cylindrical male thread plug / Nippel mit Aussengewinde zylindrisch

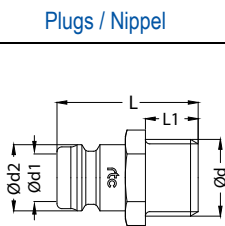

Plugs / Nippel	Size Größe	Order No / Bestellnr.	Ød	Ød1	Ød2	L	L1	HEX.
	9	090.09 PMF 10	BSP 1/8	9	13.5	24	7	14
	9	090.09 PMF 13	BSP 1/4	9	13.5	26	9	14
	9	090.09 PMF 17	BSP 3/8	9	13.5	26	9	17
	9	090.09 PMF 21	BSP 1/2	9	13.5	24	12	22
	9	090.09 PMF 1010	M10x1	9	13.5	24	7	14
	9	090.09 PMF 12175	M12x1.75	9	13.5	29	9	14
	9	090.09 PMF 1415	M14x1.5	9	13.5	26	9	15
	9	090.09 PMF 1615	M16x1.5	9	13.5	26	9	17

rtc TYPE 090.13

Cylindrical male thread plug / Nippel mit Aussengewinde zylindrisch

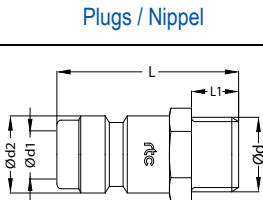

Plugs / Nippel	Size Größe	Order No / Bestellnr.	Ød	Ød1	Ød2	L	L1	HEX.
	13	090.13 PMF 21	BSP 1/2	13	19	47	12	22
	13	090.13 PMF 26	BSP 3/4	13	19	51	16	27
	13	090.13 PMF 2415	M24x1.5	13	19	51	16	27

rtc TYPE 090.09

Conical male thread plug / Nippel mit Aussengewinde konisch

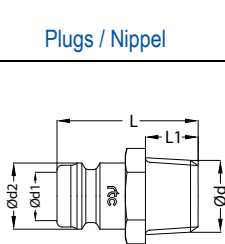

Plugs / Nippel	Size Größe	Order No / Bestellnr.	Ød	Ød1	Ød2	L	L1	HEX.
	9	090.09 PRF 13	BSPT 1/8	9	13.5	31	12	14
	9	090.09 PRF 17	BSPT 1/4	9	13.5	31	13	17
	9	090.09 PRF 21	BSPT 3/8	9	13.5	36	16	22
	9	090.09 PRF 26	BSPT 1/2	9	13.5	39.5	18	27

rtc TYPE 090

Standard hose tail plug / Nippel mit gerader Standard - Schlauchtülle

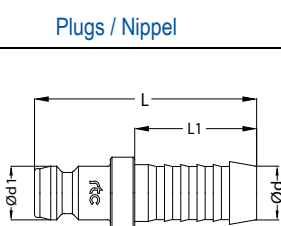

Plugs / Nippel	Size Größe	Order No / Bestellnr.	Ød	Ød1	L	L1
	6	090.06 PHF 06	6	9	39.5	22.5
	6	090.06 PHF 09	9	9	39.5	22.5
	6	090.06 PHF 13	13	9	39.5	22.5
	9	090.09 PHF 09	9	13.5	39.5	22.5
	9	090.09 PHF 13	13	13.5	42	25
	13	090.13 PHF 16	16	19	67	32
	13	090.13 PHF 19	19	19	67	32



Cylindrical male thread plug inner hex. / Nippel mit Aussengewinde zylindrisch Innensechskant

TYPE 090.06



Plugs / Nippel	Size Größe	Order No / Bestellnr.	Ød	Ød1	Ød2	L	L1	HEX.
	6	090.06 PMFH 10	BSP 1/8	6	9	24	7	5
	6	090.06 PMFH 13	BSP 1/4	6	9	26	9	5
	6	090.06 PMFH 0875	M8x075	6	9	24	8	5
	6	090.06 PMFH 1010	M10x1	6	9	24	8	5
	6	090.06 PMFH 1415	M14x1.5	6	9	27	9	5



Cylindrical male thread plug inner hex. / Nippel mit Aussengewinde zylindrisch Innensechskant

TYPE 090.09



Plugs / Nippel	Size Größe	Order No / Bestellnr.	Ød	Ød1	Ød2	L	L1	HEX.
	9	090.09 PMFH 10	BSP 1/8	9	13.5	24	7	7
	9	090.09 PMFH 13	BSP 1/4	9	13.5	26	9	7
	9	090.09 PMFH 17	BSP 3/8	9	13.5	26	9	7
	9	090.09 PMFH 1015	M10x1.5	9	13.5	26	9	7
	9	090.09 PMFH 12175	M12x1.75	9	13.5	26	9	7
	9	090.09 PMFH 1415	M14x1.5	9	13.5	26	9	7



Cylindrical male thread plug with valve / Verschlussnippel mit Aussengewinde zylindrisch

TYPE 090.06



Plugs / Nippel	Size Größe	Order No / Bestellnr.	Ød	Ød1	Ød2	L	L1	HEX.
	6	090.06 PMB 13	BSP 1/4	6	9	28	11	14
	6	090.06 PMB 17	BSP 3/8	6	9	28	11	17
	6	090.06 PMB 1415	M14x1.5	6	9	27	9	15



Cylindrical male thread plug with valve / Verschlussnippel mit Aussengewinde zylindrisch

TYPE 090.09



Plugs / Nippel	Size Größe	Order No / Bestellnr.	Ød	Ød1	Ød2	L	L1	HEX.
	9	090.09 PMB 13	BSP 1/4	9	13	29	11	14
	9	090.09 PMB 17	BSP 3/8	9	13	30	12	17
	9	090.09 PMB 21	BSP 1/2	9	13	31	12	22
	9	090.09 PMB 1415	M14x1.5	9	13	29	11	15
	9	090.09 PMB 1615	M16x1.5	9	13	30	11	17



Cylindrical male thread plug with valve / Verschlussnippel mit Aussengewinde zylindrisch

TYPE 090.13



Plugs / Nippel	Size Größe	Order No / Bestellnr.	Ød	Ød1	Ød2	L	L1	HEX.
	13	090.13 PMB 21	BSP 1/2	13	19	47	12	22
	13	090.13 PMB 26	BSP 3/4	13	19	51	16	27
	13	090.13 PMB 2415	M24x1.5	13	19	51	16	27



Push to connect hose tail plug / Nippel mit gerader Schnellsteck - Schlauchtülle

TYPE 090



Plugs / Nippel	Size Größe	Order No / Bestellnr.	Ød	Ød1	L	L1
	6	090.06 PPF 10	10	9	42	28
	9	090.09 PPF 10	10	13	43	28
	9	090.09 PPF 13	13	13	47	28
	13	090.13 PPF 16	16	19	68	38
	13	090.13 PPF 19	19	19	68	38

rtc TYPE 090.06

Male thread plug 90° / Nippel mit Aussengewinde (Metric DIN 158 - Conical DIN 2999)



Plugs / Nippel

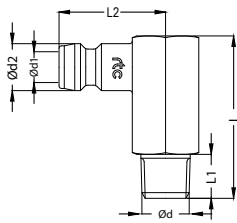

Size Größe	Order No / Bestellnr.	Ød	Ød1	Ød2	L	L1	L2	HEX.
6	090.06 PRF 10 90	BSPT 1/8	6	9	27	9	24.5	11
6	090.06 PRF 13 90	BSPT 1/4	6	9	29	11	26.5	15
6	090.06 PKF 0875 90	M8x075	6	9	27	9	24.5	11
6	090.06 PKF 1010 90	M10x1	6	9	27	9	24.5	11
6	090.06 PKF 1415 90	M14x1.5	6	9	29	11	26.5	15

rtc TYPE 090.09

Male thread plug 90° / Nippel mit Aussengewinde (Metric DIN 158 - Conical DIN 2999)



Plugs / Nippel

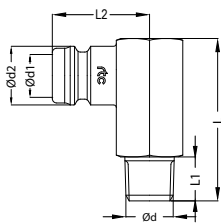

Size Größe	Order No / Bestellnr.	Ød	Ød1	Ød2	L	L1	L2	HEX.
9	090.09 PRF 13 90	BSPT 1/4	9	13	34	11	24.5	15
9	090.09 PRF 17 90	BSPT 3/8	9	13	34	11	24.5	17
9	090.09 PKF 1415 90	M14x1.5	9	13	34	11	24.5	15

rtc TYPE 090.13

Male thread plug 90° / Nippel mit Aussengewinde (Metric DIN 158 - Conical DIN 2999)



Plugs / Nippel

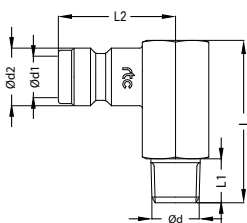

Size Größe	Order No / Bestellnr.	Ød	Ød1	Ød2	L	L1	L2	HEX.
13	090.13 PRF 21 90	BSPT 1/2	13	19	34	16	42	24
13	090.13 PRF 2415 90	M24x1.5	13	19	34	16	42	24

rtc TYPE 090.06

Cylindrical female thread plug / Nippel mit Innengewinde zylindrisch



Plugs / Nippel

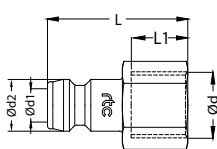

Size Größe	Order No / Bestellnr.	Ød	Ød1	Ød2	L	L1	HEX.
6	090.06 PFF 10	BSP 1/8	6	9	25	8	14
6	090.06 PFF 13	BSP 1/4	6	9	27	9	17
6	090.06 PFF 17	BSP 3/8	6	9	27	9	19

rtc TYPE 090.09

Cylindrical female thread plug / Nippel mit Innengewinde zylindrisch



Plugs / Nippel

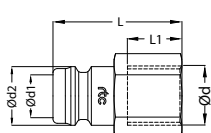

Size Größe	Order No / Bestellnr.	Ød	Ød1	Ød2	L	L1	HEX.
9	090.09 PFF 13	BSP 1/4	9	13	26	10	17
9	090.09 PFF 17	BSP 3/8	9	13	26	10	19
9	090.09 PFF 21	BSP 1/2	9	13	28	12	24



Cylindrical female thread plug / Nippel mit Innengewinde zylindrisch

TYPE 090.13



Plugs / Nippel	Size Größe	Order No / Bestellnr.	Ød	Ød1	Ød2	L	L1	HEX.
	13	090.13 PFF 21	BSP 1/2	13	19	46	14	24
	13	090.13 PFF 26	BSP 3/4	13	19	50	18	30



Plug extension / Nippelverlängerung

TYPE 090.06



Plugs / Nippel	Order No / Bestellnr.	Ød	Ød1	Ød2	L	L1	HEX.
	090.06 PEF 63	8	5	9	63	21	11
	090.06 PEF 100	8	6	9	100	21	11
	090.06 PEF 100-10	10	6	9	100	21	11
	090.06 PEF 120	10	6	9	120	21	11
	090.06 PEF 240	10	6	9	240	21	11
	090.06 PEF 360	10	6	9	360	21	11



Plug extension / Nippelverlängerung

TYPE 090.09



Plugs / Nippel	Order No / Bestellnr.	Ød	Ød1	Ød2	L	L1	HEX.
	090.09 PEF 150-10	10	6	13	150	22	14
	090.09 PEF 050	14	9	13	50	22	15
	090.09 PEF 100	14	9	13	100	22	15
	090.09 PEF 120	14	9	13	120	22	15
	090.09 PEF 150	14	9	13	150	22	15
	090.09 PEF 300	14	9	13	300	22	15
	090.09 PEF 450	14	9	13	450	22	15



Plug extension / Nippelverlängerung

TYPE 090.13



Plugs / Nippel	Order No / Bestellnr.	Ød	Ød1	Ød2	L	L1	HEX.
	090.13 PEF 500	21	13	19	500	35	22
	090.13 PEF 800	21	13	19	800	35	22

rtc TYPE 090.06 Male thread extension plug / Nippelverlängerung mit Aussengewinde

Plugs / Nippel

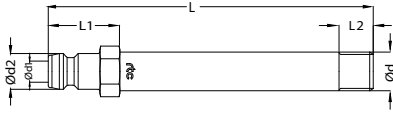

Order No / Bestellnr.	Ød	Ød1	Ød2	L	L1	L2	HEX.
090.06 PMF 10xL	BSP 1/8	6	9	*	21	7	11
090.06 PMF 13xL	BSP 1/4	6	9	*	22	9	14
090.06 PMF 0875xL	M8x0.75	6	9	*	21	7	11
090.06 PMF 1010xL	M10x1.0	6	9	*	21	7	11
090.06 PMF 1015xL	M10x1.5	6	9	*	21	9	11

*L: Length (mm): 50 / 80 / 100 / 120 / 150 / 200

rtc TYPE 090.09 Male thread extension plug / Nippelverlängerung mit Aussengewinde

Plugs / Nippel

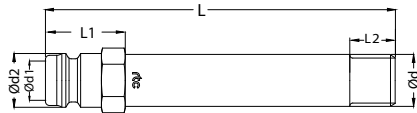

Order No / Bestellnr.	Ød	Ød1	Ød2	L	L1	L2	HEX.
090.09 PRF 13xL	BSPT 3/8	9	13.5	*	22	12	14
090.09 PRF 17xL	BSPT 1/4	9	13.5	*	22	12	17
090.09 PMF 10xL	BSP 1/8	9	13.5	*	20	7	14
090.09 PMF 13xL	BSP 1/4	9	13.5	*	20	9	14
090.09 PMF 17xL	BSP 3/8	9	13.5	*	20	9	17
090.09 PMF 08125xL	M8x1.25	9	13.5	*	20	9	14
090.09 PMF 1010xL	M10x1.0	9	13.5	*	20	10	14
090.09 PMF 1015xL	M10x1.5	9	13.5	*	20	10	14
090.09 PMF 1215xL	M12x1.5	9	13.5	*	20	11	14
090.09 PMF 12175xL	M12x1.75	9	13.5	*	20	12	14
090.09 PMF 1415xL	M14x1.5	9	13.5	*	20	12	15
090.09 PMF 1420xL	M14x2.0	9	13.5	*	20	12	15
090.09 PMF 1615xL	M16x1.5	9	13.5	*	20	13	17
090.09 PMF 1620xL	M16x2.0	9	13.5	*	20	13	17

*L: Length (mm): 50 / 80 / 100 / 120 / 150 / 200

rtc TYPE 090.06 Male long thread plug / Nippel mit langem Aussengewinde zylindrisch

Plugs / Nippel

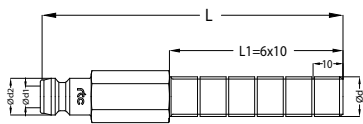

Order No / Bestellnr.	Ød	Ød1	Ød2	L	L1	HEX.
090.06 PMFL 10x100	BSP 1/8	6	9	100	6x10	11
090.06 PMFL 13x100	BSP 1/4	6	9	100	6x10	14
090.06 PMFL 17x100	BSP 3/8	6	9	100	6x10	17
090.06 PMFL 1010x100	M10x1.0	6	9	100	6x10	11
090.06 PMFL 1415x100	M14x1.5	6	9	100	6x10	14

rtc TYPE 090.09 Male long thread plug / Nippel mit langem Aussengewinde zylindrisch

Plugs / Nippel

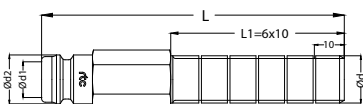

Order No / Bestellnr.	Ød	Ød1	Ød2	L	L1	HEX.
090.09 PMFL 13x100	BSP 1/4	9	13	100	6x10	14
090.09 PMFL 17x100	BSP 3/8	9	13	100	6x10	17
090.09 PMFL 1415x100	M14x1.5	9	13	100	6x10	14
090.09 PMFL 1615x100	M16x1.5	9	13	100	6x10	17



Replacement seal set / Ersatz O-Ring Set

TYPE 090



Adapter / Nippel

Order No / Bestellnr.

Ød

Ød1

Ød2

L

L1

HEX.



NFE 13-120	G 1/4	14	9	120	11	17
NFE 17-150	G 3/8	14	9	150	11	22
NFE 1415-120	M14x1.5	10	6	120	12	17
NFE 1615-150	M16x1.5	14	9	150	12	22



Replacement seal set / Ersatz O-Ring Set

TYPE 090



Seals / O-Ringe

Size
Größe

Order No / Bestellnr.

Description

Material

Working Temp.



6	SS 090.06 PN	Plug Seal Set	NBR - Nitrile	-20°C +100°C / -4°F +212°F
9	SS 090.09 PN	Plug Seal Set	NBR - Nitrile	-20°C +100°C / -4°F +212°F
13	SS 090.13 PN	Plug Seal Set	NBR - Nitrile	-20°C +100°C / -4°F +212°F
6	SS 090.06 SN	Socket Seal Set	NBR - Nitrile	-20°C +100°C / -4°F +212°F
9	SS 090.09 SN	Socket Seal Set	NBR - Nitrile	-20°C +100°C / -4°F +212°F
13	SS 090.13 SN	Socket Seal Set	NBR - Nitrile	-20°C +100°C / -4°F +212°F
6	SS 090.06 PV	Plug Seal Set	FPM - Viton	-10°C +180°C / +14°F +356°F
9	SS 090.09 PV	Plug Seal Set	FPM - Viton	-10°C +180°C / +14°F +356°F
13	SS 090.13 PV	Plug Seal Set	FPM - Viton	-10°C +180°C / +14°F +356°F
6	SS 090.06 SV	Socket Seal Set	FPM - Viton	-10°C +180°C / +14°F +356°F
9	SS 090.09 SV	Socket Seal Set	FPM - Viton	-10°C +180°C / +14°F +356°F
13	SS 090.13 SV	Socket Seal Set	FPM - Viton	-10°C +180°C / +14°F +356°F